

Model Number: ZJ-BT-RXCV-A

Product Name: RGBW BLUETOOTH LED UFO Controller



Product Parameter:

Category	LED Controller
Domination Principle	BLUETOOTH
APP	Magic Light
Language	Chinese、English、Japanese
Operation Platform	Android 4.3 or IOS 7.0 or higher
LED Drive Type	Constant voltage:MOSFET
Channels	4
Input Voltage	DC (12-24)V
Max Output Power	192W
Work For	LED Strip or other constant voltage lights
Connect Method	Common Anode
IP Rating	IP20
Working Temperature	-20-55°C
Control Distance	Visible distance 30M
Certification	CE, RoHS, FCC
Warranty	1 Year
Net Weight	42.5g
Dimension(L*B*H)	70MM*70MM*24MM
Carton Size(L*B*H)	49CM*34CM*22CM
QTY Per Carton	100Sets/CTN
Gross Weight	8kg

Controller connection mode

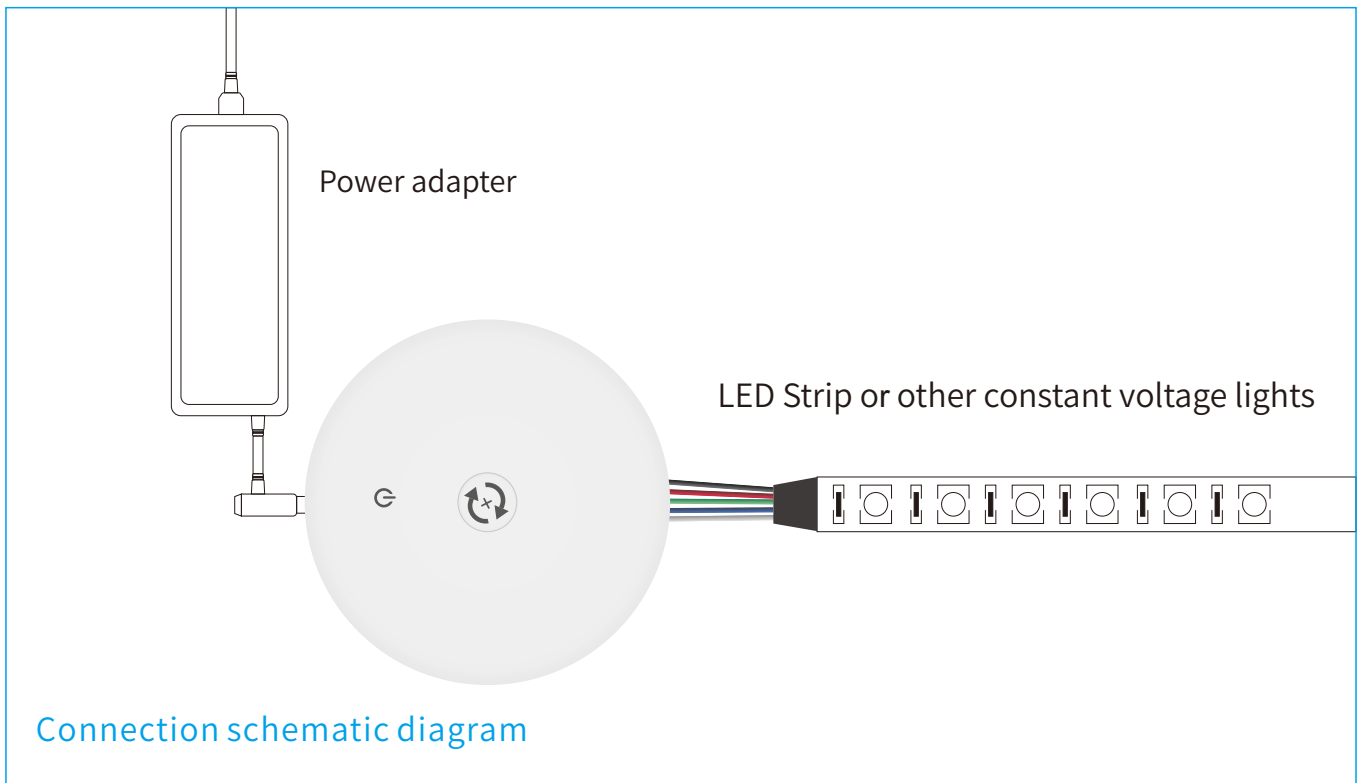

The connection between the controller and the power supply



Controller and device connection



Software User Manual for IOS

1. APP installation instructions:

Method 1: Search app individually in “APP Store”.



Magic Light

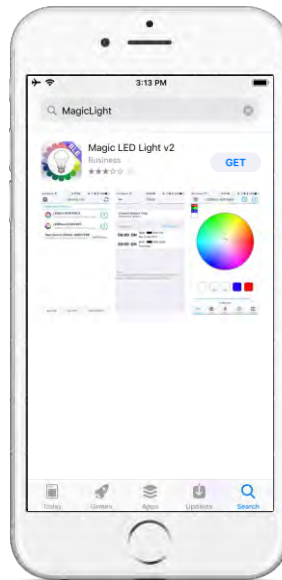

Install by QR Code

Method 2: Open QR Software then scan the below QR Code, then download & install it for free.



Installation details as below.

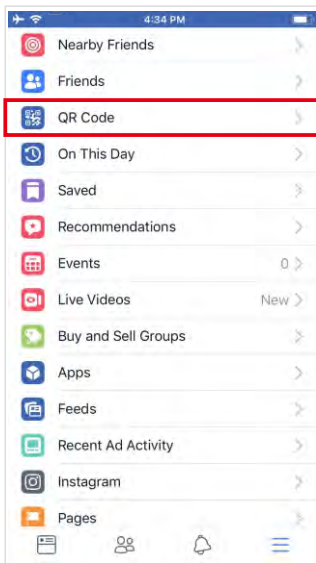

Step 1

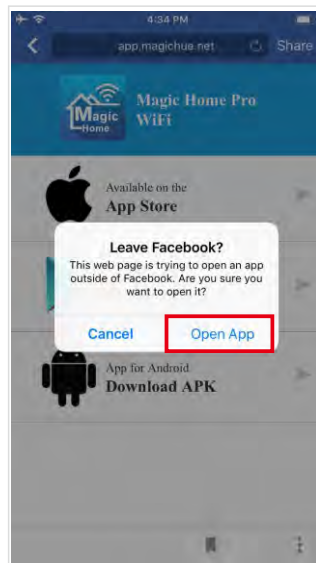

Step 2



Step 3

Software User Manual for Android.

APP installation instructions:

Method 1: Search Magic Light in “Google Play Store” or from browsers. Installation details as follow.



Step 1

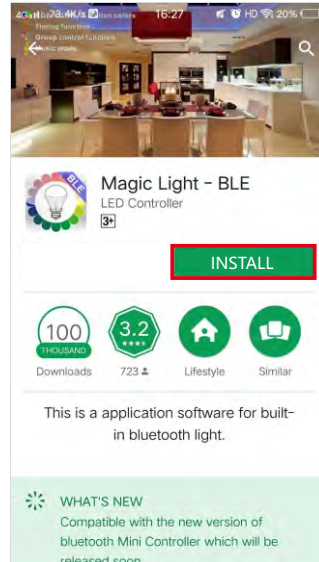

Step 2

Method 2: Scan the below QR code to download and install the app individually for free.



Installation details as below.

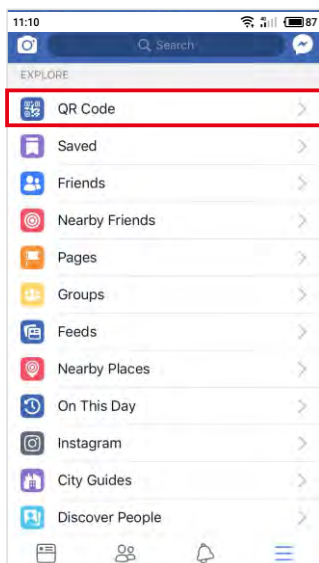

Step 1

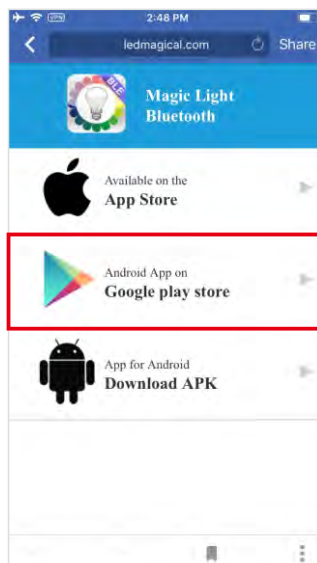

Step 2

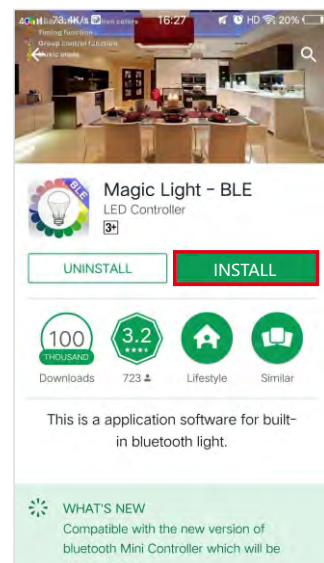

Step 3

PRODUCT FUNCTION INTRODUCTION

Support 16 million color control and brightness adjustment

You can adjust both the color RGB(Red/Green/Blue) as well as the brightness of the color. It's likewise possible in this function to adjust and store 5 own created colors and brightness levels. You can save this, if you press long on the “DIY” button.

The adjusted color/brightness will be stored and displayed in the “DIY” button. You can recall the color/brightness if you press shortly on one of the five DIY buttons.

On the display top left, the individual channels R/G/B can be called separately and adjusted from 0-255 to obtain the desired color.

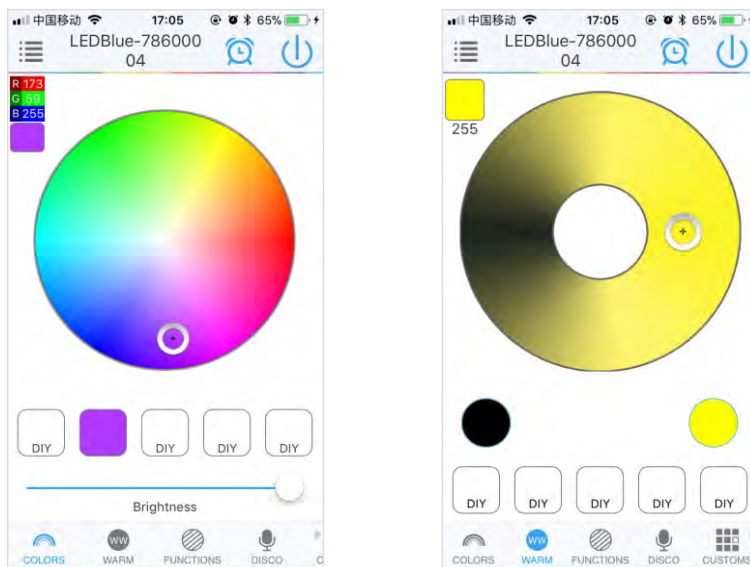

RGBW

In addition to the functions as in RGB mode, the warm white channel adjusts separately. (Warm White & RGB channels cannot be used simultaneously.)

Support for customised colours and preservation

In DIY function, you can select your favorite colors and gradual, jump or strobe between the functions. Press the menu “customs” and then “Add new Mode”. By briefly pressing one of the selection rectangles you can change the color. By pressing long, you can delete the color. It can be defined in a sequence up to 16 different colors. After setting the color, speed and award of the user mode name, press “save” on the top right. Now you see your personal role in the selection mode. You can create unlimited changing modes and they can always be edited or deleted.

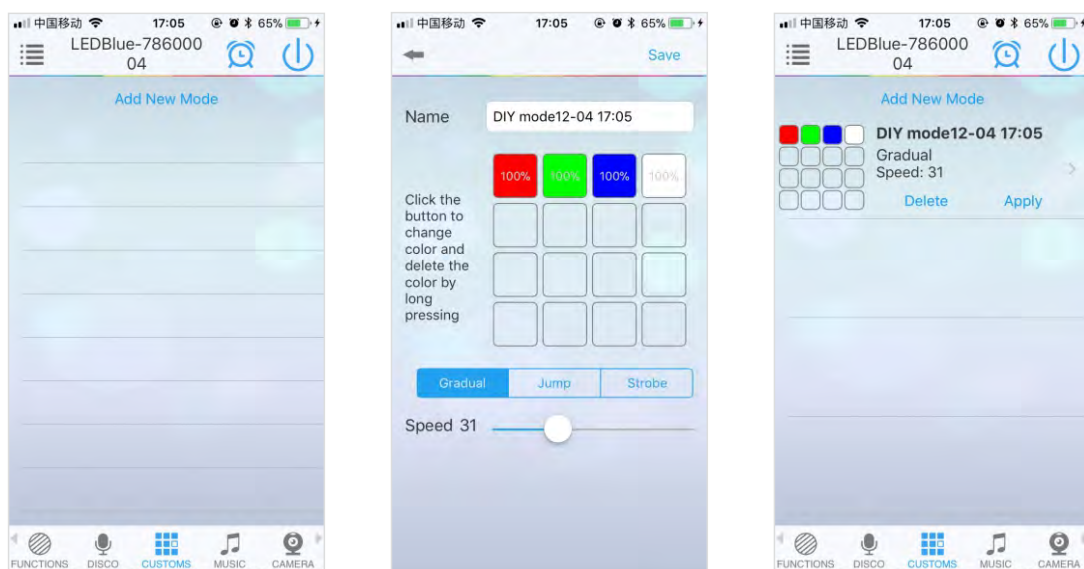

Group Feature

Zengge controllers (Magic Home Pro) allows you to create different groups to control more than one controllers, for example, if you have 2 controller units, you can use one system in your living room & the other out on your patio. The grouping function allows you to either control these systems individually or to group them together as one unit.

Light timer

You can have your lights automatically turn on or off in a specified time by setting up the timer.

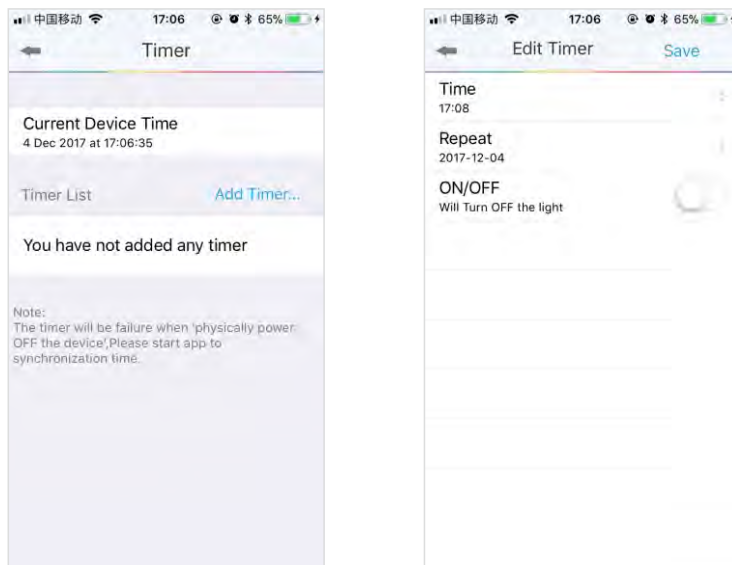

The controller has a build in timer function. To do so, press on the top right, next to ON/OFF, switch the clock icon. Then the selection menu will be shown with time, Repeat (Mon-Sun), ON/OFF switch and the optional Model (color setting, Brightness and gradient program.) The timer will not operate when the power supply is interrupted. In this case, start the APP to resynchronize.

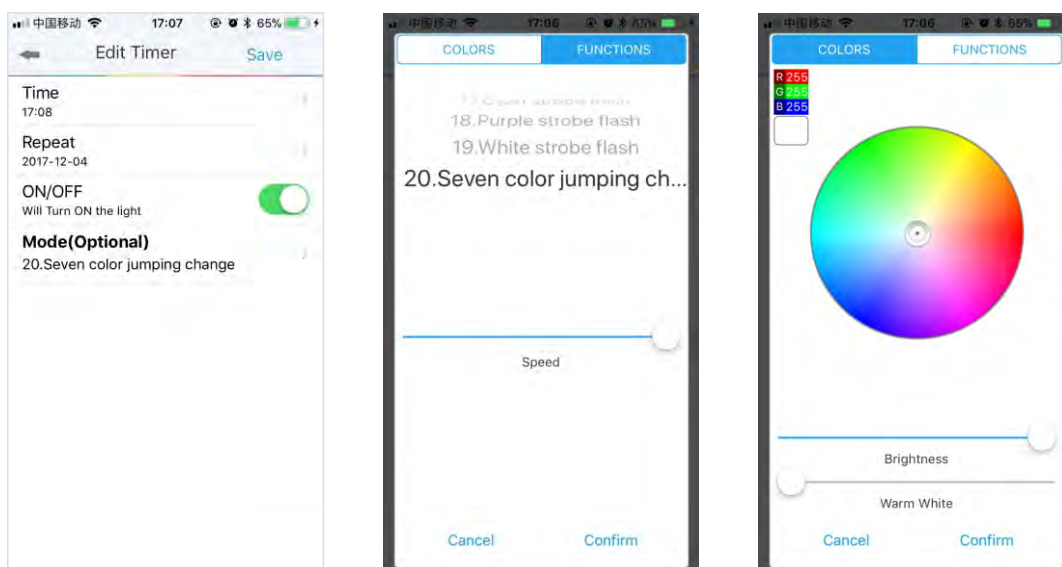

Light and music rhythm synchronization function

In this function, you can let shine the connected LED in the rhythm of the music will be played on the smartphone or tablet. To do this, select the menu item “select music” and then select your music library on smartphone or tablet the desired music.

There are four main modes for four music styles: ROCK for rock & roll music style, NORMAL for default music style, JAZZ for jazz music style, CLASSICAL for classical music style.

IOS system needs to download music files in iTunes or copy audio files from computer's iTunes to iPhone. After then, you can select the music when you open APP music mode to synchronize the lights and music rhythm. The light color changes automatically with music rhythm.

Android system needs to download the music files to the phone for use.

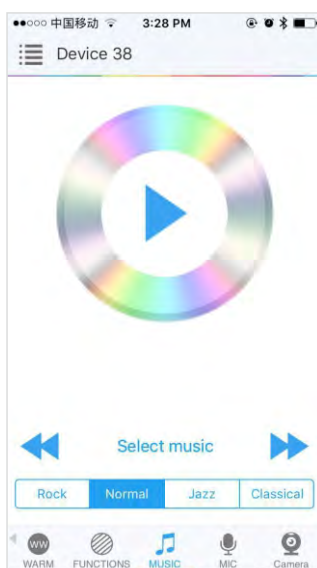

Function

In this capacity, 20 programmed are preset. In addition, you can adjust the speed of the gradients with a slider. With the keys M+/M- or scroll up and down you can switch between the preset modes.

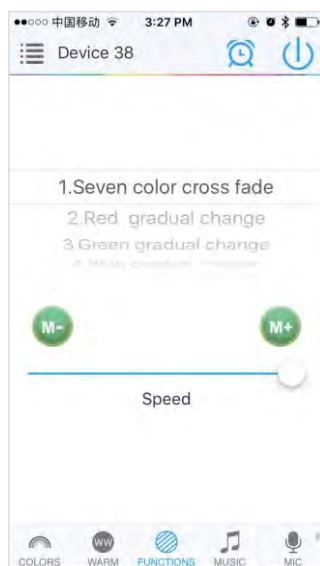

Microphone function

Click/ go to “Disco” interface of the APP.

In this function the connected LED light lights up depending on the volume/noise from the outside like a microphone. This also works when playing music or there is a noise from outside, the light will begin “dancing” base on different rhythm.

The microphone sensitivity can be adjusted by the slider.

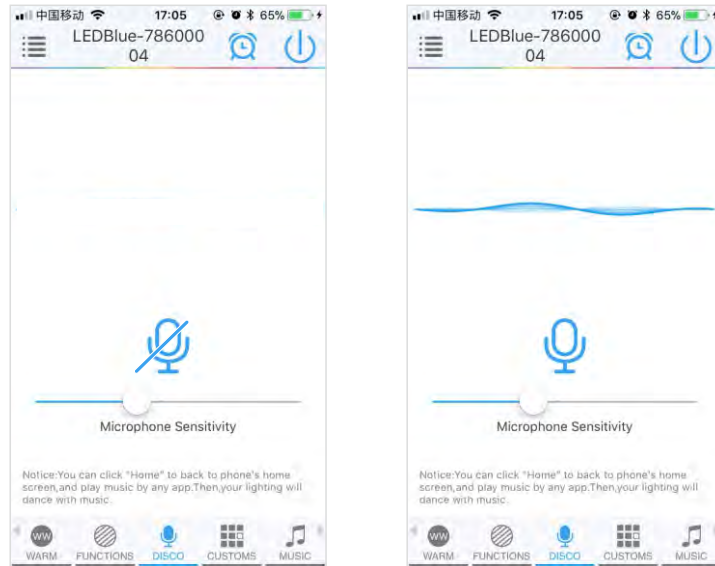

Background color function of camera

In this function, you can select a color with the smartphone or tablet where you point the camera of your smartphone or tablet to an object. The selected color will be display from the connected LED light in the RGB spectrum. This can be done manually transmitted to the LED light with “Manual” “Capture color” or switch to “Auto” and the LED light will show immediately the color which has been selected on the camera.

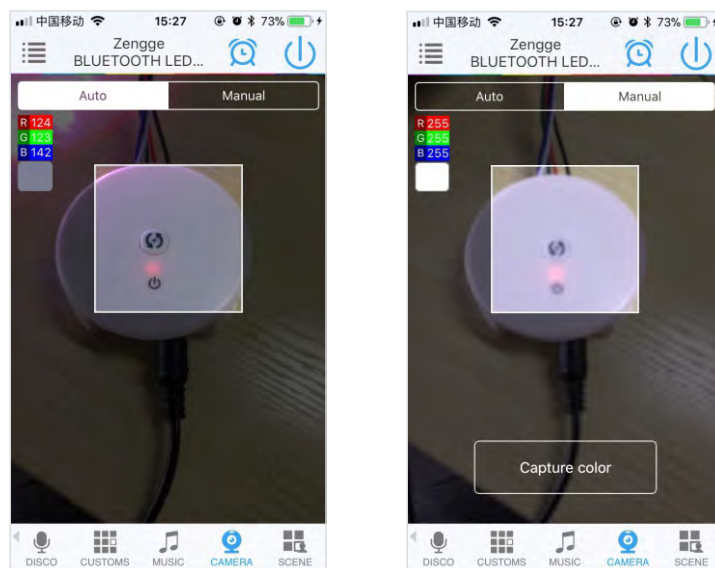

FAQ

1. [Why the controller didn't appear in the Bluetooth list of phone setting?](#)
[In order to ensure that the controller cannot be connected by others, Bluetooth controller won't appear in the setting list. Just open the APP with Bluetooth enabled and the controller will show up.](#)
2. [Why the controllers didn't appear in the app after I opened the phone Bluetooth?](#)
[In order to ensure the privacy of the controller, the controller needs to be successfully connected with the phone within one minute after powering on. If more than one minute, please restart your controller.](#)

light off

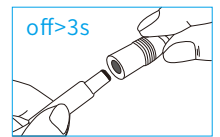
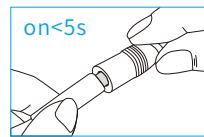
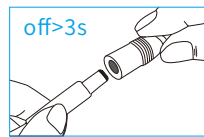
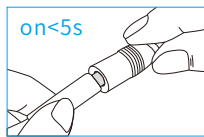
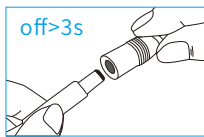
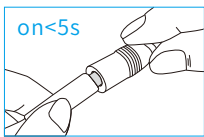

light strobe

ATTENTIONS

1. Please use the product in a dry environment.
2. Please use the input voltage at 5-28V DC voltage, must not connect into 220V AC directly.
3. The product is requested common anode connection. The wrong connection will cause a malfunction.